

**IEEE/PES TRANSFORMERS COMMITTEE**  
**www.transformerscommittee.org**  
**Spring 2008 Meeting; March 16-20, 2008**  
**Hosted by Robert Thompson and Shaw EDS, Inc.**  
**Charlotte Westin Hotel; Charlotte, North Carolina USA**

**NOTES:** See Page 5 for a key to abbreviations. A vertical line in the left margin indicates a noteworthy revision since last revision.

<u>DATE/TIME</u>	<u>ACTIVITY</u>	<u>SUB-COM</u>	<u>ACTIVITY CHAIR</u>	<u>ROOM CAP/ARR/AV</u>	<u>MEETING ROOM (Floor)</u>
<b>Saturday, March 15 (no meeting registration this day)</b>					
	No Meeting Registration, No Meetings, No Social Events				
<b>Sunday, March 16</b>					
8:00 am - 4:00 pm	<u>Sunday Day Tour</u> : "Biltmore Estate". Advanced Registration Necessary. Limited Attendance. -- The bus departs the Westin at 8:00 am and return ~4:00 pm. Includes lunch. Eat breakfast beforehand. -- Contact Ms. Jackie Panos at (704) 331-1316 or <a href="mailto:jackie.panos@shawgrp.com">jackie.panos@shawgrp.com</a> for questions.				
1:00 pm - <u>5:30 pm</u>	Meeting Registration (only open until 5:30 pm)				Grand Promenade (Level 2)
2:00 pm - 5:30 pm	Administrative SC -- closed meeting, by invitation only	Admin.	T. Prevost	24 US (w/snack buffet)	Harris Room (Level 2)
2:00 pm - 5:30 pm	NEMA Transformers -- closed meeting, by invitation only	++	C. Drexler	15 US (w/beverages)	Trade Room (Level 2)
6:00 pm - 8:00 pm	Welcome Reception -- All Attendees & Companions are Welcome!			350 Reception	Grand Ballroom CD (Level 2)
<b>Monday, March 17 (No Break Sponsors at this Meeting ***)</b>					
7:00 am - 5:00 pm	Meeting Registration				Grand Promenade (Level 2)
7:00 am - 6:00 pm	Internet Cafe'			12 SQ	Sharon Room
<u>7:00 am</u> - 7:50 am	<u>Newcomers Orientation</u> Breakfast Mtg ( <u>arrive early!</u> ) -- Newcomers & Guests are encouraged to attend!		E. Smith	35 CL	Tryon Room (Level 2)
7:00 am - 7:45 am	Distribution SC Coordination Meeting (closed mtg)		K. Hanus	14 CONF	Fireside Room (Ember Grill Rest.)
7:00 am - 8:00 am	Breakfast - Attendees (no companions please)			250 RT (8/tbl)	Grand Ballroom D
8:00 am - 9:00 am	Breakfast - Companions (no meeting attendees please)			60 RT (8/tbl)	Providence Ballroom 1 (near Lobby)
9:15 am - 4:00 pm	<u>Companion Tour</u> : "Tour of Duke Mansion and Charlotte Historical Areas." Includes lunch at the Mansion. -- Advance registration required. Bus departs the Westin Hotel at 9:15 am and returns around 4:00 pm.				
	<del>WG Elect. Test Data Report C57.12.37</del>	<del>Dist</del>	Moved to Tuesday afternoon, 3:15 pm.		
8:00 am - 10:45 am	IEC TC-14 Technical Advisory Group (all interested individuals welcome)	++	P. Hopkinson	14 CONF (w/perim. chairs)	Stonewall Room
8:00 am - 9:15 am	WG Dry-Type Reactors C57.16	Dry	R. Dudley	25 CL	Trade
8:00 am - 9:15 am	WG 3-ph Underground Distribution Transformers C57.12.24	UTNP	G. Termini	35 CL	Independence
8:00 am - 9:15 am	TF Arc Furnace Transformers C57.17	Power	D. Corsi	50 CL	Tryon
8:00 am - 9:15 am	TF Electrical Partial Discharge Measurements Guide C57.113	DiTests	E. Lemke	80 CL S3	Grand Ballroom A
8:00 am - 9:15 am	Short Circuit Tests Guide C57.133 and revision to C57.12.90, Section 12	PCS	M. Fortin	100 CL S3	Grand Ballroom B
8:00 am - 9:15 am	WG Transformer Monitoring C57.143	Power	D. Chu/A. Lux	150 CL S3	Grand Ballroom C
9:15 am - 9:30 am	<i>Break (beverages only)</i>			Grand Promenade	

\*\*\* Contact Joe Watson ([joe\\_watson@ieee.org](mailto:joe_watson@ieee.org)) if you are interested in sponsoring coffee-breaks at a future meeting.

<u>DATE/TIME</u>	<u>ACTIVITY</u>	<u>SUB-COM</u>	<u>ACTIVITY CHAIR</u>	<u>ROOM CAP/ARR/AV</u>	<u>MEETING ROOM</u>
<b>Monday, March 17 (continued)</b>					
9:30 am - 10:45 am	WG Sealed Dry-Type Power Transformers C57.12.52	Dry	S. Kennedy	25 CL	Trade
9:30 am - 10:45 am	WG Liquid-immersed Secondary Network Transformers C57.12.40	UTNP	B. Klaponski	35 CL	Independence
9:30 am - 10:45 am	WG Revision of C57.12.10	Power	J. Arteaga	50 CL	Tryon
9:30 am - 10:45 am	WG Overhead Distribution Transformers C57.12.20	Dist	A. Wilks/ T.Cooper	80 CL S3	Grand Ballroom A
9:30 am - 10:45 am	TF Furan Tests <b>(New!)</b>	IL	K. Haggerty	100 CL S3	Grand Ballroom B
9:30 am - 10:45 am	WG PCS Rev. to Test Code C57.12.90	PCS	M. Perkins	150 CL S3	Grand Ballroom C
10:45 am - 11:00 am	<i>Break (beverages only)</i>			Grand Promenade	
	<del>WG Shunt Reactors C57.24</del>	<del>PCS</del>	Will not meet. Successful ballot, submitted to RevCom.		
11:00 am - 12:15 pm	WG Dry-Type Gen. Require. C57.12.01	Dry	J. Sullivan	25 CL	Trade
11:00 am - 12:15 pm	(TBD)			35 CL	Independence
11:00 am - 12:15 pm	WG Control Cabinets PC57.148	Power	J. Watson	50 CL	Tryon
11:00 am - 12:15 pm	WG 1-ph Padmount Distribution Transformers C57.12.38 (12.21 & 12.25)	Dist	A. Ghafourian/ I. Ares	80 CL S3	Grand Ballroom A
11:00 am - 12:15 pm	WG Revision to Low Frequency Tests	DiTests	B. Poulin	100 CL S3	Grand Ballroom B
11:00 am - 12:15 pm	WG Thermal Evaluation of Power and Distribution Transformers C57.100	IL	R. Wicks	150 CL S3	Grand Ballroom C
12:15 pm - 1:30 pm	<u>Lunch Meeting</u> : Standards Development Review -- All activity chairs are encouraged to attend. -- Advance reservation required (\$20 for box lunch). -- No paper tickets. Admission verified at the door.		B. Bartley	120 RT (8/tbl)	Grand Ballroom D
1:45 pm - 3:00 pm	WG Thermal Evaluation C57.12.56/60	Dry	R. Wicks	25 CL	Trade
1:45 pm - 3:00 pm	<b>SC HVDC Converter Transformers and Smoothing Reactors</b>	HVDC	R. Dudley	35 CL	Independence
1:45 pm - 3:00 pm	WG 3-ph Padmount Distribution Transformers C57.12.34	Dist	R. Stahara/ S. Shull	50 CL	Tryon
1:45 pm - 3:00 pm	WG Tap Changer Performance C57.131	Power	W. Henning	80 CL S3	Grand Ballroom A
1:45 pm - 3:00 pm	TF Special Dielectric Test Issues <b>(New!)</b>	DiTests	B. Forsyth	100 CL S3	Grand Ballroom B
1:45 pm - 3:00 pm	WG Frequency Response Analysis (FRA) Guide PC57.149	PCS	C. Sweetser	150 CL S3	Grand Ballroom C
3:00 pm - 3:15 pm	<i>Break (beverages and treats)</i>			Grand Promenade	
	<del>WG 1-ph Submersible Distribution Transformers C57.12.23</del>	<del>UTNP</del>	Will not meet. Guide is complete and ready for ballot.		
3:15 pm - 4:30 pm	Joint WG Optical Instrument Transf. C57.13/PSIM P1601	IT/PSIM	Rahmatian/ Gilleland	25 CL	Trade
3:15 pm - 4:30 pm	WG Dry-Type Test Code C57.12.91	Dry	D. Foster	35 CL	Independence
3:15 pm - 4:30 pm	TF IEEE-IEC Cross Reference	Stds	J. Sim	50 CL	Tryon
3:15 pm - 4:30 pm	WG Transf. Paralleling Guide <b>(New!)</b>	Power	T. Jauch	80 CL S3	Grand Ballroom A
3:15 pm - 4:30 pm	WG Impulse Test Guides C57.98 & C57.138	DiTests	A. Molden	100 CL S3	Grand Ballroom B
3:15 pm - 4:30 pm	WG PCS Revisions to C57.12.00	PCS	S. Snyder	150 CL S3	Grand Ballroom C
4:30 pm - 4:45 pm	<i>Break (beverages only)</i>			Grand Promenade	
4:45 pm - 6:00 pm	<u>Presentation #1</u> : "Short Circuit Strength and Testing", by Marcel Fortin, Juergen Gerth, Richard McLaughlin & Pierre Riffon. Sponsored by PCS. **			200 CL S3 (add 50-75 TH seats in rear)	Grand Ballroom C
6:30 pm - 8:00 pm	NEMA Power Transformer Interest Dinner Meeting Open to member and non-member power transformer manufacturers. Dinner sponsored by NEMA. Contact John Caskey at joh_caskey@nema.org for more details.			20 US	Harris Room

\*\* Contact N. Kent Haggerty (n.kent.haggerty@ieee.org) if you are interested in making a technical presentation at a future meeting.

<u>DATE/TIME</u>	<u>ACTIVITY</u>	<u>SUB-COM</u>	<u>ACTIVITY CHAIR</u>	<u>ROOM CAP/ARR/AV</u>	<u>MEETING ROOM</u>
<b>Tuesday, March 18 ***</b>					
	No NEMA ST-1/ST-20 Meeting				
7:00 am - 12:00 pm	Meeting Registration				Grand Promenade
7:00 am - 6:00 pm	Internet Cafe'			12 SQ	Sharon Room
7:00 am - 8:00 am	Breakfast - Attendees (no companions please)			250 RT (8/tbl)	Grand Ballroom D
8:00 am - 9:00 am	Breakfast - Companions (no meeting attendees please)			60 RT (8/tbl)	Providence Ballroom 1 (near Lobby)
9:15 am - 4:30 pm	<u>Companion Tour: "SouthPark Mall and Mint Museum of Craft + Design".</u> -- Advance registration required. Lunch on your own. -- Bus departs Westin Hotel at 9:15 am and returns at 4:30 pm (see flyer for details on optional early return).				
8:00 am - 9:15 am	WG Test Requirements for HV Instrument Transformers C57.13.5	IT	R. McTaggart/ P. Riffon	25 CL	Trade
8:00 am - 9:15 am	TF Transf. Tank Rupture & Mitigation	Power	P. Zhao	35 CL	Independence
8:00 am - 9:15 am	WG Enclosure Integrity C57.12.28, C57.12.29, C57.12.31, C57.12.32	Dist	R. Olen/ D. Mulkey	50 CL	Tryon
8:00 am - 9:15 am	WG Rev. Field Test Guide IEEE 62	Stds	J. Verner	80 CL S3	Grand Ballroom A
8:00 am - 9:15 am	WG Natural Ester-based Fluids C57.147	IF	P. McShane	100 CL S3	Grand Ballroom B
8:00 am - 9:15 am	WG Switching Transients Induced by Transf./Breaker Interaction PC57.142	PCS	R. Degeneff	150 CL S3	Grand Ballroom C
9:15 am - 9:30 am	<i>Break (beverages only)</i>			Grand Promenade	
9:30 am - 10:45 am	WG Terminal Markings C57.12.70	Stds	S. Shull	25 CL	Trade
9:30 am - 10:45 am	WG Neutral Ground. Devices PC57.32	PCS	S. Schappell	35 CL	Independence
9:30 am - 10:45 am	TF Functional Life Tests, De-energized Tap Changers (DETC)	Power	P. Hopkinson	50 CL	Tryon
9:30 am - 10:45 am	TF GSU Bushing Standardization	Bush	L. Recksiedler	80 CL S3	Grand Ballroom A
9:30 am - 10:45 am	TF DGA Natural Ester Fluids ( <b>New!</b> )	IF	P. Boman	100 CL S3	Grand Ballroom B
9:30 am - 10:45 am	WG Revision to Loading Guide C57.91	IL	T. Raymond	150 CL S3	Grand Ballroom C
10:45 am - 11:00 am	<i>Break (beverages only)</i>			Grand Promenade	
11:00 am - 12:15 pm	WG Loss Tolerance and Measurement	PCS	E. teNyenhuis	25 CL	Trade
11:00 am - 12:15 pm	WG Phase-shift Transf. Guide C57.135	Power	J. Sim	35 CL	Independence
11:00 am - 12:15 pm	TF External Dielectric Clearances ( <b>New!</b> )	DiTests	E. Davis	50 CL	Tryon
11:00 am - 12:15 pm	TF Transformer Efficiency and Loss Evaluation (DOE Activity)	Dist	P. Hopkinson	80 CL S3	Grand Ballroom A
11:00 am - 12:15 pm	WG Guide for DGA in LTCs C57.139	IF	F. Jakob	100 CL S3	Grand Ballroom B
11:00 am - 12:15 pm	WG Temperature Rise Test Procedures in Section 11 of C57.12.90	IL	P. Powell	150 CL S3	Grand Ballroom C
12:15 pm - 1:30 pm	<u>Speaker Luncheon</u> by Mr. Brew Barron, Duke Energy -- Advance registration is necessary. -- Paper tickets are not provided. Admission verified at the door.			160 CL (8/tbl) with elevated table for 5	Grand Ballroom D
1:45 pm - 3:00 pm	WG Revision to IEEE 638	Power	C. Swinderman	25 CL	Trade
1:45 pm - 3:00 pm	WG HVDC Bushings C57.19.03 ( <b>New!</b> )	Bush	F. Elliott	35 CL	Independence
1:45 pm - 3:00 pm	WG Sound Level Measurement Guide	ASV	J. Puri	50 CL	Tryon
1:45 pm - 3:00 pm	WG Voltage Step Regulators C57.15	Dist	Colopy/Kennedy	80 CL S3	Grand Ballroom A
1:45 pm - 3:00 pm	WG Revision to Gas Guide C57.104	IF	R. Ladroga	100 CL S3	Grand Ballroom B
1:45 pm - 3:00 pm	WG Dielectric Test Tables, Liquid-filled	DiTests	P. Hopkinson	150 CL S3	Grand Ballroom C
3:00 pm - 3:15 pm	<i>Break (beverages and treats)</i>			Grand Promenade	

\*\*\* Contact Joe Watson (joe\_watson@ieee.org) if you are interested in sponsoring coffee-breaks at a future meeting.

<u>DATE/TIME</u>	<u>ACTIVITY</u>	<u>SUB-COM</u>	<u>ACTIVITY CHAIR</u>	<u>ROOM CAP/ARR/AV</u>	<u>MEETING ROOM</u>
<b>Tuesday, March 18 (continued)</b>					
	<del>WG for Bar Coding Distribution Transformers C57.12.35</del>	Dist	Will not meet.	Revised standard has been published.	
3:15 pm - 4:30 pm	WG Semiconductor Rectifier Transformers C57.18.10	PCS	S. Kennedy	25 CL	Trade
3:15 pm - 4:30 pm	WG Bushing Application Guide C57.19.100	Bush	T. Spitzer	35 CL	Independence
3:15 pm - 4:30 pm	TF Guide for Retrofill of Natural Ester Fluids <b>(New!)</b>	IF	J. Graham	50 CL	Tryon
3:15 pm - 4:30 pm	WG Electronic Test Data Reporting C57.12.37	Dist	Hollingsworth/ Callsen	80 CL S3	Grand Ballroom A
3:15 pm - 4:30 pm	WG Transportation Issues Guide	Power	G. Anderson	100 CL S3	Grand Ballroom B
3:15 pm - 4:30 pm	WG Revision to Impulse Tests	DiTests	P. Riffon/ P. Heinzig	150 CL S3	Grand Ballroom C
4:30 pm - 4:45 pm	<i>Break (beverages only)</i>			Grand Promenade	
4:45 pm - 6:00 pm	<u>Presentation #2</u> : "US National Energy Policy", by Phil Hopkinson and Nigel McQuin. Sponsored by PCS. **			200 CL S3 (add 50-75 TH seats in rear)	Grand Ballroom C
<b>Wednesday, March 19 ***</b>					
	No Meeting Registration, No Companion Tours				
7:00 am - 6:00 pm	Internet Cafe'			12 SQ	Sharon Room
7:00 am - 8:00 am	Breakfast - Attendees (no companions please)			<u>200</u> RT (8/tbl)	Grand Ballroom D
8:00 am - <u>9:30 am</u>	Breakfast - Companions (no meeting attendees please)			60 RT (8/tbl)	Providence 1
7:00 am - 7:45 am	<b>SC Meetings Planning</b> Get breakfast in Ballroom D and take to Ballroom A. Arrive early!	Mtgs	G. Anderson	50 CL S3	Grand Ballroom A
8:00 am - 9:15 am	EL&P Delegation (Users only meeting)	++	K. Hanus	30 CL	Independence
8:00 am - 9:15 am	<b>SC Instrument Transformer</b>	IT	J. Smith	50 CL S3	Grand Ballroom A
8:00 am - 9:15 am	<b>SC Audible Sound &amp; Vibration</b>	ASV	J. Puri	100 CL S3	Grand Ballroom B
8:00 am - 9:15 am	<b>SC Insulation Life</b>	IL	D. Platts	200 CL S3	Grand Ballroom C
9:15 am - 9:30 am	<i>Break (beverages only)</i>			Grand Promenade	
9:30 am - 10:45 am	<b>SC UG Transf. &amp; Network Protectors</b>	UTNP	C. Niemann	50 CL S3	Grand Ballroom A
9:30 am - 10:45 am	(TBD)			100 CL S3	Grand Ballroom B
9:30 am - 10:45 am	<b>SC Dielectric Tests</b>	DiTests	L. Wagenaar	200 CL S3	Grand Ballroom C
10:45 am - 11:00 am	<i>Break (beverages only)</i>			Grand Promenade	
11:00 am - 12:15 pm	(TBD)			50 CL S3	Grand Ballroom A
11:00 am - 12:15 pm	<b>SC Insulating Fluids</b>	IF	R. Ladroga	100 CL S3	Grand Ballroom B
11:00 am - 12:15 pm	<b>SC Performance Characteristics</b>	PCS	R. Girgis	200 CL S3	Grand Ballroom C
12:15 pm - 1:30 pm	Lunch (on your own)				
1:30 pm - 2:45 pm	<b>SC Dry Type</b>	Dry	C. Johnson	50 CL S3	Grand Ballroom A
1:30 pm - 2:45 pm	(TBD)			100 CL S3	Grand Ballroom B
1:30 pm - 2:45 pm	<b>SC Power Transformers</b>	Power	T. Lundquist	200 CL S3	Grand Ballroom C
2:45 pm - 3:00 pm	<i>Break (beverages and treats)</i>			Grand Promenade	

\*\* Contact N. Kent Haggerty (n.kent.haggerty@ieee.org) if you are interested in making a technical presentation at a future meeting.

\*\*\* Contact Joe Watson (joe\_watson@ieee.org) if you are interested in sponsoring coffee-breaks at a future meeting.

## KEY

Note: A PC projector will be furnished in each meeting room. Arrive early to ensure that equipment operates/synchs correctly. Overhead projectors are available in the meeting registration area.

> -- activity continued into another session / from another session  
++ -- not a Transformers Committee activity    TBD = "To Be Determined"  
FC = flip chart; S1 = sound (see note)  
S2 = stand mic in front only; S3 = one stand mic in front & stand mic(s) at mid-room

CL -- classroom seating (w/head table for 2-3)  
TH -- theater seating (with head table for 2-3)  
RT -- multiple roundtables (8-9/table)  
US -- U-shape table

<u>DATE/TIME</u>	<u>ACTIVITY</u>	<u>SUB-COM</u>	<u>ACTIVITY CHAIR</u>	<u>ROOM CAP/ARR/AV</u>	<u>MEETING ROOM</u>
<b>Wednesday, March 19 (continued)</b>					
3:00 pm - 4:15 pm	(TBD)			50 CL S3	Grand Ballroom A
3:00 pm - 4:15 pm	<b>SC Bushings</b>	Bush	F. Elliott	100 CL S3	Grand Ballroom B
3:00 pm - 4:15 pm	<b>SC Distribution Transformers</b>	Dist	K. Hanus	200 CL S3	Grand Ballroom C
4:15 pm - 4:30 pm	<i>Break (beverages only)</i>			Grand Promenade	
4:30 pm - 5:30 pm	<b>SC Transformer Standards</b>	Stds	B. Bartley	100 CL S3	Grand Ballroom B
6:00 pm - 10:00 pm	<u>Dinner Social</u> : Dinner at the "Discovery Place". Advance registration is necessary. -- Buses begin boarding at 5:45 pm. The last bus departs at 6:15 pm. All buses return before 10:00 pm. -- Paper tickets will not be provided. Admission will be verified with a registration list as you board the bus.				
<b>Thursday, March 20</b>					
No Meeting Registration, No Companion Tours, No Internet Cafe', No EPRI Meeting					
7:00 am - 8:00 am	Breakfast - Attendees (no companions please)			<u>200</u> RT (6/tbl)	Grand Ballroom D
8:00 am - <u>9:30 am</u>	Breakfast - Companions (no meeting attendees please)			50 RT(8/tbl)	Providence 1
8:00 am - 9:45 am >	General Session, Transformers Committee -- <u>All attendees</u> are encouraged to attend. -- See separate document for meeting agenda.		T. Prevost	200 CL S1 50 TH elevat. table for 4	Grand Ballroom C
9:45 am - 10:00 am	<i>Break (beverages only)</i>			Grand Promenade	
> 10:00 am - 11:30 am	General Session, Transformers Committee		T. Prevost	200 CL S1 50 TH	Grand Ballroom C
<u>12:00 pm</u> - 9:00 pm	<u>Technical Tour #1</u> : ABB Dry-Type Transformers Facility in Bland, Virginia. By Invitation Only. Invitations will be mailed directly from ABB. Contact Randy Bridges at (276) 688-1505 or randy.bridges@us.abb.com for more information. Includes a box lunch on the bus and dinner that evening. The bus will depart the Westin Hotel at 12:00 pm and return around 9:00 pm.				
<u>12:00 pm</u> - 10:30 pm	<u>Technical Tour #2</u> : Federal Pacific Transformer & Switchgear Facility in Bristol, Virginia. By Invitation Only. Invitations will be mailed directly from Federal Pacific. Contact Ms. Jody Dutcher at (276) 645-8238 or jdutch@federalpacific.com for more information. Includes a box lunch on the bus and dinner in Bristol, VA. The bus will depart the Westin Hotel at 12:00 pm and return around 10:30 pm.				

## Friday, March 21

No Transformer Committee Meetings, No Internet Cafe', No EPRI Meeting

# THE WESTIN

## CHARLOTTE

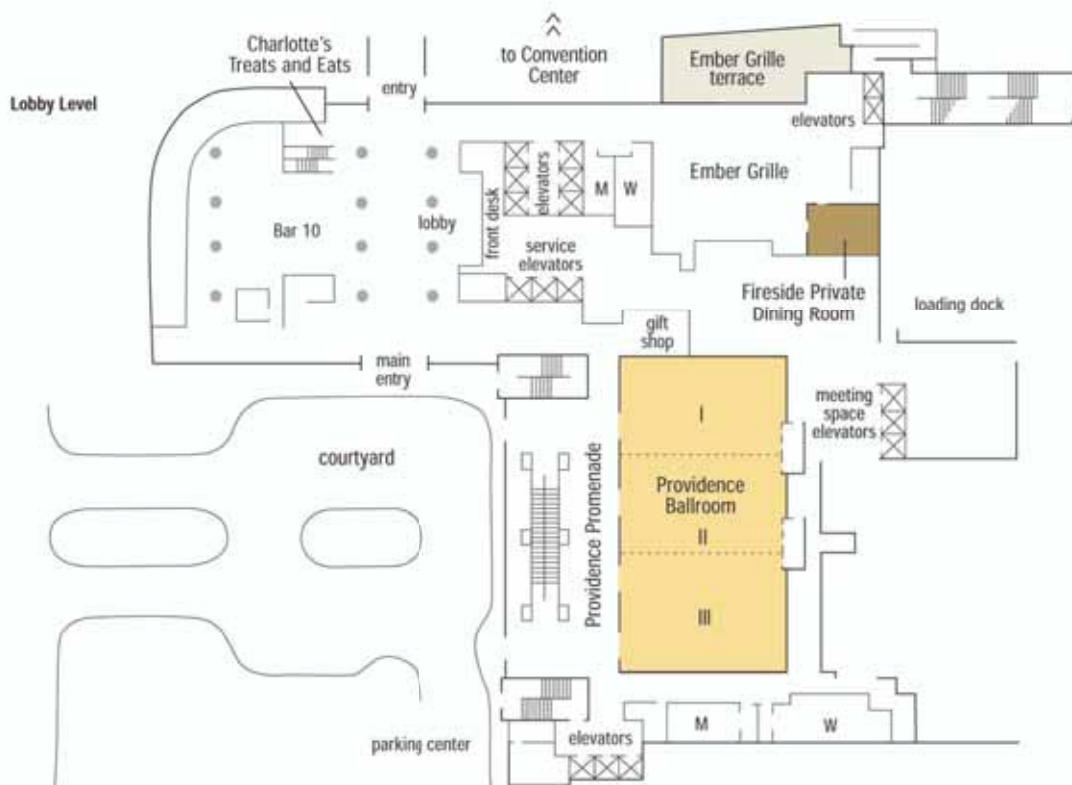

**Level Two**

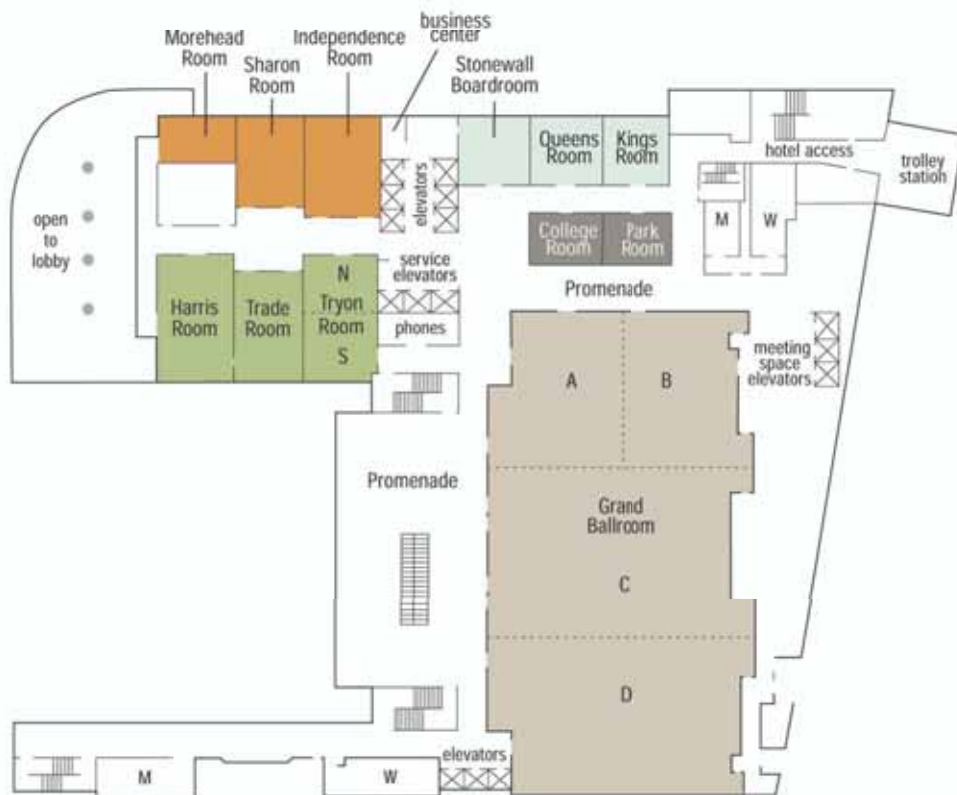

**Level Three**

