

KEY

**Note:** A PC projector will be furnished in each meeting room. Arrive early to ensure equipment operates/syncs correctly.

> = activity continued into another session / from another session

++ = not a Transformers Committee activity

TBD = To Be Determined

TRACK LEGEND

Admin	Administrative SC	Ins Life	Insulation Life SC
Bush	Bushings SC	Instr TR	Instrument Transformers SC
DiTests	Dielectric Tests SC	Mtgs	Meetings Planning SC
Distr	Distribution Transformers SC	PCS	Performance Characteristics SC
Dry Type	Dry Type Transformers SC	Power	Power Transformers SC
HVDC	HVDC Converter Transfs. and Smoothing Reactors SC	STNP	Submersible Transf. & Network Protectors SC
IF	Insulating Fluids SC	Stds	Standards SC

STATUS LEGEND

N	New
I	In-Progress
NC	Near Completion
B	Ballot Stage
C	Complete
E	Entity

SATURDAY, MARCH 18

No Events Planned

SUNDAY, MARCH 19

TIME	ACTIVITY	TRACK	MTG CHAIR	STATUS	ROOM (FLOOR)
1:00 PM – 5:30 PM	Meeting Registration				Regency Prefunction (2)
2:00 PM – 5:00 PM	Administrative Subcommittee - Closed meeting, by invitation only	Admin	E. teNyenhuis	–	Milwaukee (2)
2:00 PM – 5:00 PM	NEMA Transformers - Closed meeting, by invitation only	++	J. Stewart	–	Executive AB (2)
6:00 PM – 8:00 PM	Welcome Reception Renew old friendships and form new ones! This reception will be held inside the beautiful Regency Ballroom, so weather will not be an issue. Cash bars, plenty of fabulous food and live music will be provided. Please indicate whether you will attend this reception during the meeting registration process. All registered attendees and spouses/companions are welcome to attend.				Regency Ballroom (2)

**MONDAY, MARCH 20 Breaks Sponsored by The H-J Family of Companies\***

TIME	ACTIVITY	TRACK	MTG CHAIR	STATUS	ROOM (FLOOR)
7:00 AM – 5:00 PM	Meeting Registration				Regency Prefunction (2)
7:00 AM – 7:50 AM	Newcomers Orientation - Arrive early, grab breakfast and get a good seat - Newcomers and guests are encouraged to attend		D. Wallach	—	Lakeshore Ballroom (1)
7:00 AM – 8:00 AM	Breakfast - Attendees (no spouses/companions please)				Atrium (2)
8:00 AM – 9:30 AM	Breakfast - Spouses/Companions (no meeting attendees please)				Vue (21)
8:00 AM – 9:15 AM	Opening Session - All registered meeting participants are encouraged to attend - See separate document on website for meeting agenda - Attendance required to maintain Committee Member status		E. teNyenhuis	—	Regency Ballroom (2)
9:30 AM – 3:15 PM	Spouses/Companions Tour: Ethnic Milwaukee Food Tour - Advance on-line registration required — space is limited! - Lunch included at the historic On the Clock bar and grill - See website/flyer for details	Tour			
9:15 AM – 9:30 AM	Break (beverages only): The H-J Family of Companies				Atrium (2)
9:30 AM – 10:45 AM	TF IEEE-IEC Cross Reference	Stds	A. Washburn	I	Gilpatrick (1)
9:30 AM – 10:45 AM	WG Guide of FRA for Liquid Filled Transf. C57.149	PCS	C. Sweetser	I	Lakeshore Ballroom (1)
9:30 AM – 10:45 AM	WG Standard Requirements for Tap Changers - C57.131	Power	C. Colopy	I	Milwaukee (2)
9:30 AM – 10:45 AM	WG Std Transf. Terminology C57.12.80	Stds	D. Sauer	I	Executive Ballroom (2)
9:30 AM – 10:45 AM	TF Transf Efficiency & Loss Evaluation (DOE Activity)	Distr	P. Hopkinson	I	Regency B (2)
9:30 AM – 10:45 AM	TF Guide for Tank Rupture Mitigation C57.156	Power	P. Zhao	N	Regency A (2)
10:45 AM – 11:00 AM	Break (beverages only): The H-J Family of Companies				Atrium (2)
11:00 AM – 12:15 PM	WG Overhead Distr. Transf. C57.12.20	Distr	A. Traut	I	Lakeshore Ballroom (1)
11:00 AM – 12:15 PM	WG Loading Guide PC57.91	Ins Life	D. Wallach	I	Executive Ballroom (2)
11:00 AM – 12:15 PM	WG Class 1E Transf.for Nuclear Power Gen Std. 638	Power	C. Swinderman	I	Regency A (2)
11:00 AM – 12:15 PM	WG Guide for Field Testing PC57.152	Stds	M. Ferreira	I	Milwaukee (2)
11:00 AM – 12:15 PM	TF Partial Discharge Tests for Class I Trfs	DiTests	D. Ayers	I	Regency B (2)
11:00 AM – 12:15 PM	WG Guide for DGA in Silicone PC57.146	IF	P. Boman	I	Gilpatrick (1)
12:15 PM – 1:30 PM	Standards Development Review Luncheon Everyone is welcome to attend. All SC/WG/TF leaders are highly encouraged to attend. Doors open ~12:00 pm. Come early, get a good seat and start eating. Advance on-line registration required. To listen to the presentation without eating lunch, arrive by 12:30 pm.				Regency CD (2)
1:45 PM – 3:00 PM	WG 1-ph Padmount Dist Transf. C57.12.38	Distr	A. Ghafourian	I	Executive Ballroom (2)
1:45 PM – 3:00 PM	WG Dry Type Gen. Requirements C57.12.01	Dry Type	C. Ballard	I	Milwaukee (2)
1:45 PM – 3:00 PM	WG Guide for Phase Shifting Transf C57.135	Power	E. Schweiger	N	Regency A (2)
1:45 PM – 3:00 PM	WG Sec. Network Protectors C57.12.44	STNP	M. Faulkner	I	Lakeshore Ballroom (1)
1:45 PM – 3:00 PM	TF Audible Sound Revs & WG Sound Guide C57.136 (S. Antosz)	PCS	R. Girgis	I	Regency B (2)
1:45 PM – 3:00 PM	WG App of High-Temp Insulation Matrs IEEE 1276 Annex B	Ins Life	K. Biggie	I	Gilpatrick (1)
3:00 PM – 3:15 PM	Break (beverages and treats): The H-J Family of Companies				Atrium (2)
3:15 PM – 4:30 PM	WG 3-ph Padmount Dist Transf. C57.12.34	Distr	S. Shull	I	Milwaukee (2)
3:15 PM – 4:30 PM	WG Transformer Monitoring C57.143	Power	M. Spurlock	I	Lakeshore Ballroom (1)
3:15 PM – 4:30 PM	WG Transformer Impulse Test Guide PC57.98	DiTests	T. Hochanh	I	Executive Ballroom (2)
3:15 PM – 4:30 PM	TF Test for Eval of Insulation for Dry-Type Transfs IEEE 259	Dry Type	D. Stankes	I	Gilpatrick (1)
3:15 PM – 4:30 PM	TF PCS Cont. Revisions to C57.12.00	PCS	T. Ansari	I	Regency B (2)
3:15 PM – 4:30 PM	WG Bushing Applicat. Guide C57.19.100	Bush	T. Spitzer	I	Regency A (2)
4:30 PM – 4:45 PM	Break (beverages only): The H-J Family of Companies				Atrium (2)
4:45 PM – 6:00 PM	WG Submersible Transf. C57.12.24	STNP	B. Garcia	I	Milwaukee (2)
4:45 PM – 6:00 PM	TF Tank Touch Temperatures	Distr	B. Webb	N	Regency A (2)
4:45 PM – 6:00 PM	WG Failure Investigation & Reporting PC57.125	Power	H. Sahin	N	Regency B (2)
4:45 PM – 6:00 PM	TF Inverter Transf Precautions on Ground Shields C57.159	PCS	P. Hopkinson	N	Executive Ballroom (2)
4:45 PM – 6:00 PM	TF Core Ground & Winding Insul. Resistance - Perf & Int.	DiTests	D. Robalino	N	Gilpatrick (1)
4:45 PM – 6:00 PM	SC HVDC Converter Transfs & Smoothing Reactors	HVDC	U. Radbrandt	-	Lakeshore Ballroom (1)
6:15 PM – 10:00 PM	Technical Tour: Prolec GE Waukesha Advance registration required—space is limited to one bus! Admission confirmed with badge at bus. Start loading bus for Prolec GE Waukesha's power transformer manufacturing facility at the hotel's Martin Luther King Drive entrance at ~6:15 PM and depart at 6:30 PM. Dinner provided on-site at the PGE Waukesha facility. Return at ~10:00 PM. See website/flyer for more information.	Tech Tour			

**TUESDAY, MARCH 21 Breaks Sponsored by Central Moloney, Inc.\***

TIME	ACTIVITY	TRACK	MTG CHAIR	STATUS	ROOM (FLOOR)
7:00 AM – 11:30 AM	Meeting Registration				Regency Prefunction (2)
7:00 AM – 7:50 AM	EL&P Delegation (End-users only please) - Arrive early and grab breakfast from Regency AB		J. Murphy	—	Crystal (2)
7:00 AM – 8:00 AM	Breakfast - Attendees (no spouses/companions please)				Regency CD (2)
8:00 AM – 9:30 AM	Breakfast - Spouses/Companions (no meeting attendees please)				Vue (21)
11:00 AM – 2:00 PM	Spouses/Companions Tour: Hands-On Cooking Class - Advance on-line registration required — limited to 20 people! - Held upstairs at the Milwaukee Public Market - See flyer for details	Tour			
8:00 AM – 9:15 AM	TF Guide for Life Tests of Switch Contacts C57.157	Power	A. Sewell	N	Gilpatrick (1)
8:00 AM – 9:15 AM	WG Condition Assessment Guide PC57.170	Power	K. Mani	I	Lakeshore Ballroom (1)
8:00 AM – 9:15 AM	WG Power-Line Carrier Coupling Cap & Volt Transf. C57.13.9	Instr TR	Z. Roman	I	Milwaukee (2)
8:00 AM – 9:15 AM	WG Practice for Install & Operation of Dry Type PC57.94	Dry Type	K. Klein	I	Regency A (2)
8:00 AM – 9:15 AM	WG Encl Int C57.12.28, C57.12.29, C57.12.31, C57.12.32	Distr	D. Mulkey	I	Regency B (2)
8:00 AM – 9:15 AM	TF on Revision of Impulse Tests C57.12.00 & C57.12.90	DiTests	S. Plante	I	Executive Ballroom (2)
9:15 AM – 9:30 AM	Break (beverages only): Central Moloney, Inc.				Atrium (2)
9:30 AM – 10:45 AM	WG Low Frequency Test Guide PC57.168	DiTests	D. Sauer	I	Lakeshore Ballroom (1)
9:30 AM – 10:45 AM	WG Transportation Issues C57.150	Power	G. Anderson	I	Executive Ballroom (2)
9:30 AM – 10:45 AM	TF Instrument Transf. Accuracy	Instr TR	I. Ziger	I	Gilpatrick (1)
9:30 AM – 10:45 AM	WG Bushings IEC/IEEE 65700.19.03 Dual Logo	Bush	E. Weatherbee	I	Milwaukee (2)
9:30 AM – 10:45 AM	TF PCS Cont. Rev. to Test Code C57.12.90	PCS	H. Sahin	I	Regency B (2)
9:30 AM – 10:45 AM	WG Guide for DGA Applied to Factory Temp Rise Test C57.130	IF	B. Forsyth	I	Regency A (2)
10:45 AM – 11:00 AM	Break (beverages only): Central Moloney, Inc.				Atrium (2)
11:00 AM – 12:15 PM	WG Sw Transients Ind by TR/Bkr Interaction PC57.142	PCS	J. McBride	I	Executive Ballroom (2)
11:00 AM – 12:15 PM	WG Liquid-immersed Sec. Network TRs C57.12.40	STNP	J. Vartanian	I	Lakeshore Ballroom (1)
11:00 AM – 12:15 PM	WG Requirements for Instrument Transformers PC57.13	Instr TR	D. Wallace	I	Milwaukee (2)
11:00 AM – 12:15 PM	WG Guide for Loading Dry Type Transformers C57.96	Dry Type	A. Narawane	I	Gilpatrick (1)
11:00 AM – 12:15 PM	TF Standard Requirements for Arc Furnace Transf. C57.17	Power	D. Corsi	N	Regency B (2)
11:00 AM – 12:15 PM	TF Guide for the Reclamation of Mineral Oil C57.637	IF	S. Denzer	N	Regency A (2)
12:15 PM – 1:30 PM	Awards Luncheon All meeting attendees are encouraged to attend to show appreciation and recognize accomplishments. Doors open ~12:00 pm. Come early, get a good seat and start eating. Advance on-line registration is required.				Regency CD (2)
1:45 PM – 3:00 PM	WG Consolidation Insulating Fluid Guides PC57.166	IF	T. Prevost	I	Lakeshore Ballroom (1)
1:45 PM – 3:00 PM	WG Bar Coding for Distr Transf. C57.12.35	Distr	R. Chrysler	I	Executive Ballroom (2)
1:45 PM – 3:00 PM	TF Cont. Revision to Low Frequency Tests C57.12.90	DiTests	A. Varghese	I	Milwaukee (2)
1:45 PM – 3:00 PM	WG Guide for Mitigating Corrosion on Sub Trfs C57.12.53	STNP	W. Elliott	I	Regency A (2)
1:45 PM – 3:00 PM	WG Volts per Hertz C57.107	Power	J. Watson	I	Regency B (2)
1:45 PM – 3:00 PM	OPEN				
3:00 PM – 3:15 PM	Break (beverages and pretzels): Central Moloney, Inc.				Atrium (2)
3:15 PM – 4:30 PM	WG Recommend Practice for Routine Impulse Tests C57.138	DiTests	H. Sahin	N	Milwaukee (2)
3:15 PM – 4:30 PM	TF Guide for Install & Maintenance of Power Trf C57.93	Power	S. Reed	I	Lakeshore Ballroom (1)
3:15 PM – 4:30 PM	WG Dry Type PD Detection PC57.124	Dry Type	T. Prevost	I	Gilpatrick (1)
3:15 PM – 4:30 PM	WG Geomagnetic Disturbances PC57.163	Stds	D. Blaydon	I	Executive Ballroom (2)
3:15 PM – 4:30 PM	TF Continuous Rev Clause 11 Temp Rise Tests C57.12.90	Ins Life	D. Sankarakurup	I	Regency B (2)
3:15 PM – 4:30 PM	WG Guide DGA in Ester-Immersed Transformers PC57.155	IF	A. Sbravati	N	Regency A (2)
4:30 PM – 4:45 PM	Break (beverages only): Central Moloney, Inc.				Atrium (2)
4:45 PM – 6:00 PM	WG Guide for PD Measure HV Bushings & Inst Trf C57.160	DiTests	T. Hochanh	NC	Gilpatrick (1)
4:45 PM – 6:00 PM	TF Reverse Power Flow Effects on Trans	Stds	D. Blaydon	N	Lakeshore Ballroom (2)
4:45 PM – 6:00 PM	WG Guide for DGA in LTCs C57.139	IF	R. Frotscher	I	Milwaukee (2)
4:45 PM – 6:00 PM	WG Neutral Grounding Devices C57.32	PCS	S. Kennedy	N	Executive Ballroom (2)
4:45 PM – 6:00 PM	TF Guide for Paralleling Transformers C57.153	Power	M. Tostrud	N	Regency B (2)
4:45 PM – 6:00 PM	WG Dry Type Test Code C57.12.91	Dry Type	D. Walker	N	Regency A (2)
6:15 PM – 10:30 PM	Technical Tour: Eaton Advance registration required—space is limited to two buses! Admission confirmed with badge at bus. Start loading buses for Eaton's Badger Drive facility in Waukesha at the hotel's Martin Luther King Drive entrance at ~6:15 PM and depart promptly at 6:30 PM. Dinner provided on-site at the Eaton facility. Return at ~10:30 PM. See website/flyer for more information.	Tech Tour			

**WEDNESDAY, MARCH 22 Breaks Sponsored by Virginia & Georgia Transformer\***

No Meeting Registration, Technical Tours, Spouse/Companion Tours, or Social Events Planned						
TIME	ACTIVITY	TRACK	MTG CHAIR	STATUS	ROOM (FLOOR)	
7:00 AM – 8:00 AM	Breakfast - Attendees (no spouses/companions please)				Regency CD (2)	
7:00 AM – 8:00 AM	SC Meetings Planning - Arrive early and grab breakfast from Regency AB - All interested individuals welcome	Mtgs	T. Behrens	—	Crystal (2)	
7:00 AM – 8:30 AM	IEC TC-14 Technical Advisory Group - Breakfast Meeting - arrive early - All interested individuals welcome		P. Hopkinson	—	Lakeshore Ballroom (1)	
8:00 AM – 9:30 AM	Breakfast - Spouses/Companions (no meeting attendees please)				Vue (21)	
8:00 AM – 9:15 AM	SC Instrument Transformers	Instr TR	T. Sizemore	—	Executive Ballroom (2)	
8:00 AM – 9:15 AM	SC Insulation Life	Ins Life	S. Sharpless	—	Regency AB (2)	
9:15 AM – 9:30 AM	Break (beverages only): Virginia & Georgia Transformer				Atrium (2)	
9:30 AM – 10:45 AM	SC Distribution Transformers	Distr	E. Smith	—	Executive Ballroom (2)	
9:30 AM – 10:45 AM	SC Bushings	Bush	E. Weatherbee	—	Regency AB (2)	
10:45 AM – 11:00 AM	Break (beverages only): Virginia & Georgia Transformer				Atrium (2)	
11:00 AM – 12:15 PM	SC Submersible Transf. & Network Protectors	STNP	G. Payerle	—	Executive Ballroom (2)	
11:00 AM – 12:15 PM	SC Dielectric Test	DiTests	P. Patel	—	Regency AB (2)	
12:15 PM – 1:30 PM	Lunch Break					
1:30 PM – 2:45 PM	SC Dry Type Transformers	Dry Type	C. Ballard	—	Executive Ballroom (2)	
1:30 PM – 2:45 PM	SC Power Transformers	Power	R. Musgrove	—	Regency AB (2)	
2:45 PM – 3:00 PM	Break (beverages and treats): Virginia & Georgia Transformer				Atrium (2)	
3:00 PM – 4:15 PM	SC Insulating Fluids	IF	S. Reed	—	Executive Ballroom (2)	
3:00 PM – 4:15 PM	SC Performance Characteristics	PCS	R. Verdolin	—	Regency AB (2)	
4:15 PM – 4:30 PM	Break (beverages only): Virginia & Georgia Transformer				Atrium (2)	
4:30 PM – 5:45 PM	SC Standards	Stds	D. Sauer	—	Regency AB (2)	
6:00 PM – 10:00 PM	Harley-Davidson Museum - Advance on-line registration required; admission confirmed with name badge at location - Transportation will be available with first run departing hotel at 5:45 PM and running every 15 minutes until 7:30 PM; first return shuttle departs H-D Museum at 8:30 PM and will run approximately every 15 minutes, with last run at 10:00 PM - Enjoy museum exhibits and gift shop before and/or after dinner at your own pace — with or without headset/audio tour; NO FOOD OR BEVERAGES ARE ALLOWED IN THE MUSEUM - Appetizers, buffet dinner and cash bars (credit cards accepted) in the Rumble Room, which is connected to the museum by an enclosed walkway; see flyer for details	Social				

**THURSDAY, MARCH 23**

No Meeting Registration, Technical Tours, Spouse/Companion Tours, or Social Events Planned						
TIME	ACTIVITY	TRACK	MTG CHAIR	STATUS	ROOM (FLOOR)	
7:00 AM – 8:00 AM	Breakfast - Attendees (no spouses/companions please)				Atrium (2)	
8:00 AM – 9:30 AM	Breakfast - Spouses/Companions (no meeting attendees please)				Vue (21)	
8:00 AM – 9:15 AM	Technical Presentation 1 Tutorial on the DOE NOPR for Distribution Transformers Efficiency Requirements and its Implications by Phil Hopkinson, Colby Lovins, Bryan Marquardt, Aaron Meyers, Dan Mulkey, Joe Tedesco and Alan Traut - See flyer on website for details **	Tutorial			Regency Ballroom (2)	
9:15 AM – 9:30 AM	Break (beverages only)					
9:30 AM – 10:45 AM	Technical Presentation 2 Tutorial on Innovative Solutions to Increase Overload Capability for Oil and Dry-Type Transformer Bushings by Kurt Kaineder and Alfons Schrammel - See flyer on website for details **	Tutorial			Regency Ballroom (2)	
10:45 AM – 11:00 AM	Break (beverages only)					
11:00 AM – 12:00 PM	Closing Session - All attendees are encouraged to attend - See separate document on website for meeting agenda		E. teNyenhuis		Regency Ballroom (2)	
12:00 PM	Lunch (on your own)					
12:15 PM – 3:30 PM	Technical Tour: Dynamic Ratings Advance registration required. Space is limited to 25 attendees! Admission confirmed with badge at bus. Start loading bus at ~12:15 PM at the hotel's Martin Luther King Drive entrance and depart promptly at 12:30 PM. Lunch served at the Dynamic Ratings facility upon arrival. Return at ~3:30 PM. See website/flyer for more information.	Tech Tour				

\* Contact Ed Smith (edsmith@ieee.org) if you are interested in sponsoring a day of coffee breaks at a future meeting.

\*\* Contact Tom Prevost (tprevost@ieee.org) if you are interested in making a technical presentation at a future meeting.

**FUTURE COMMITTEE MEETINGS**

**Fall 2023:** Kansas City, Missouri USA, October 22 – 26, 2023

**Spring 2024:** Vancouver, BC Canada, March 10 – 14, 2024

**Fall 2024:** St. Louis, Missouri, October 27 – 31, 2024

**Spring 2025:** Denver, Colorado USA, March 23 – 27, 2025

## FIRST FLOOR

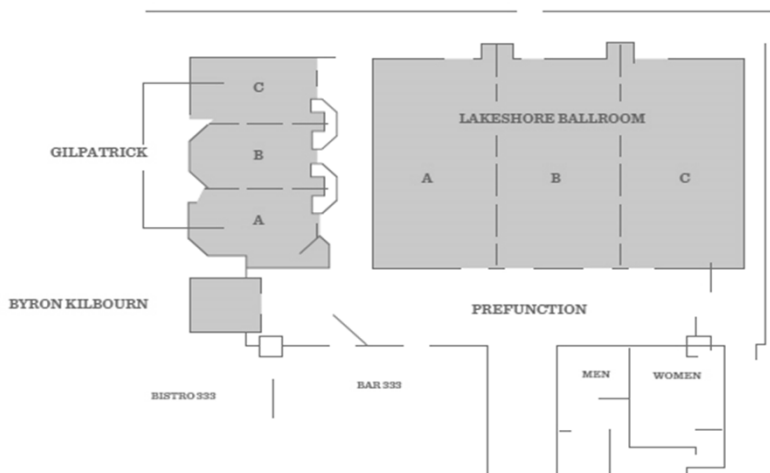

## VUE-21<sup>ST</sup> FLOOR Rooftop

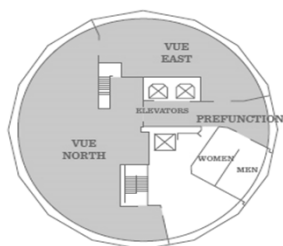

## SECOND FLOOR

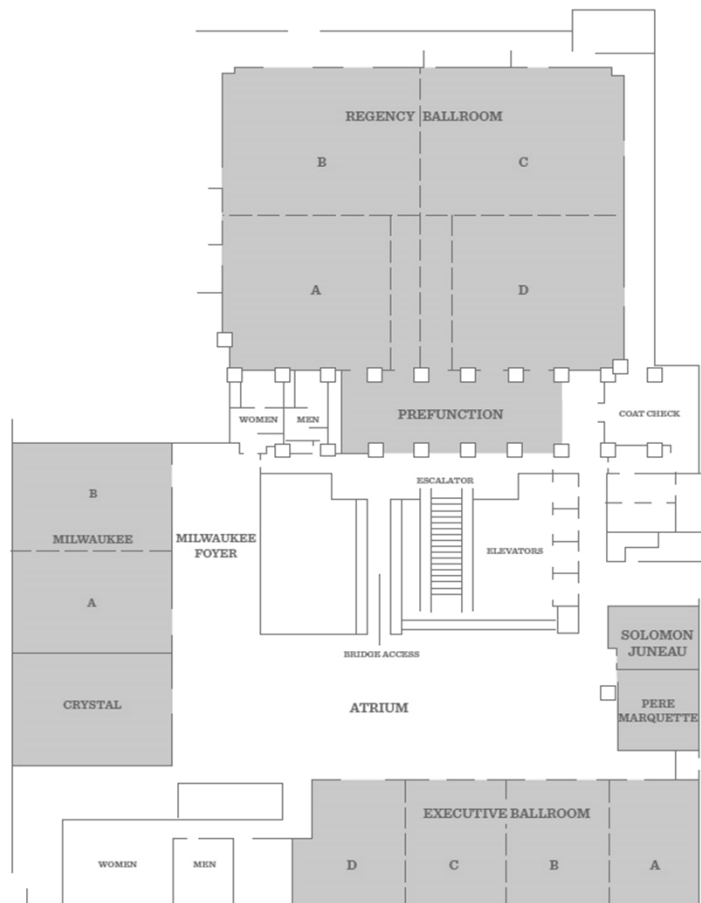

**Page intentionally left blank**

## SUBCOMMITTEE MEETING LIST

## SPRING 2023 MEETING: MARCH 19 TO MARCH 23

Hyatt Regency; Milwaukee, WI USA

Date	Time Start	Time End	Session Title	Track	Chair	Room/Location
3/19/2023	2:00 PM	5:00 PM	Administrative Subcommittee - Closed meeting, by invitation only	Admin	E. teNyenhuis	Milwaukee (2)
3/20/2023	3:15 PM	4:30 PM	WG Bushing Applicat. Guide C57.19.100	Bush	T. Spitzer	Regency A (2)
3/21/2023	9:30 AM	10:45 AM	WG Bushings IEC/IEEE 65700.19.03 Dual Logo	Bush	E. Weatherbee	Milwaukee (2)
3/22/2023	9:30 AM	10:45 AM	SC Bushings	Bush	E. Weatherbee	Regency AB (2)
3/20/2023	9:30 AM	10:45 AM	TF Transf Efficiency & Loss Evaluation (DOE Activity)	Distr	P. Hopkinson	Regency B (2)
3/20/2023	11:00 AM	12:15 PM	WG Overhead Distr. Transf. C57.12.20	Distr	A. Traut	Lakeshore Ballroom (1)
3/20/2023	1:45 PM	3:00 PM	WG 1-ph Padmount Dist Transf. C57.12.38	Distr	A. Ghafourian	Executive Ballroom (2)
3/20/2023	3:15 PM	4:30 PM	WG 3-ph Padmount Dist Transf. C57.12.34	Distr	S. Shull	Milwaukee (2)
3/20/2023	4:45 PM	6:00 PM	TF Tank Touch Temperatures	Distr	B. Webb	Regency A (2)
3/21/2023	8:00 AM	9:15 AM	WG Encl Int C57.12.28, C57.12.29, C57.12.31, C57.12.32	Distr	D. Mulkey	Regency B (2)
3/21/2023	1:45 PM	3:00 PM	WG Bar Coding for Distr Transf. C57.12.35	Distr	R. Chrysler	Executive Ballroom (2)
3/22/2023	9:30 AM	10:45 AM	SC Distribution Transformers	Distr	E. Smith	Executive Ballroom (2)
3/20/2023	11:00 AM	12:15 PM	TF Partial Discharge Tests for Class I Trfs	DiTests	D. Ayers	Regency B (2)
3/20/2023	3:15 PM	4:30 PM	WG Transformer Impulse Test Guide PC57.98	DiTests	T. Hochanh	Executive Ballroom (2)
3/20/2023	4:45 PM	6:00 PM	TF Core Ground & Winding Insul. Resistance - Perf & Int.	DiTests	D. Robalino	Gilpatrick (1)
3/21/2023	8:00 AM	9:15 AM	TF on Revision of Impulse Tests C57.12.00 & C57.12.90	DiTests	S. Plante	Executive Ballroom (2)
3/21/2023	9:30 AM	10:45 AM	WG Low Frequency Test Guide PC57.168	DiTests	D. Sauer	Lakeshore Ballroom (1)
3/21/2023	1:45 PM	3:00 PM	TF Cont. Revision to Low Frequency Tests C57.12.90	DiTests	A. Varghese	Milwaukee (2)
3/21/2023	3:15 PM	4:30 PM	WG Recommend Practice for Routine Impulse Tests C57.138	DiTests	H. Sahin	Milwaukee (2)
3/21/2023	4:45 PM	6:00 PM	WG Guide for PD Measure HV Bushings & Inst Trf C57.160	DiTests	T. Hochanh	Gilpatrick (1)
3/22/2023	11:00 AM	12:15 PM	SC Dielectric Test	DiTests	P. Patel	Regency AB (2)
3/20/2023	1:45 PM	3:00 PM	WG Dry Type Gen. Requirements C57.12.01	Dry Type	C. Ballard	Milwaukee (2)
3/20/2023	3:15 PM	4:30 PM	TF Test for Eval of Insulation for Dry-Type Transfs IEEE 259	Dry Type	D. Stankes	Gilpatrick (1)
3/21/2023	8:00 AM	9:15 AM	WG Practice for Install & Operation of Dry Type PC57.94	Dry Type	K. Klein	Regency A (2)
3/21/2023	11:00 AM	12:15 PM	WG Guide for Loading Dry Type Transformers C57.96	Dry Type	A. Narawane	Gilpatrick (1)
3/21/2023	3:15 PM	4:30 PM	WG Dry Type PD Detection PC57.124	Dry Type	T. Prevost	Gilpatrick (1)
3/21/2023	4:45 PM	6:00 PM	WG Dry Type Test Code C57.12.91	Dry Type	D. Walker	Regency A (2)
3/22/2023	1:30 PM	2:45 PM	SC Dry Type Transformers	Dry Type	C. Ballard	Executive Ballroom (2)
3/20/2023	4:45 PM	6:00 PM	SC HVDC Converter Transfs & Smoothing Reactors	HVDC	U. Radbrandt	Lakeshore Ballroom (1)
3/20/2023	11:00 AM	12:15 PM	WG Guide for DGA in Silicone PC57.146	IF	P. Boman	Gilpatrick (1)
3/21/2023	9:30 AM	10:45 AM	WG Guide for DGA Applied to Factory Temp Rise Test C57.130	IF	B. Forsyth	Regency A (2)
3/21/2023	11:00 AM	12:15 PM	TF Guide for the Reclamation of Mineral Oil C57.637	IF	S. Denzer	Regency A (2)
3/21/2023	1:45 PM	3:00 PM	WG Consolidation Insulating Fluid Guides PC57.166	IF	T. Prevost	Lakeshore Ballroom (1)
3/21/2023	3:15 PM	4:30 PM	WG Guide DGA in Ester-Immersed Transformers PC57.155	IF	A. Sbravati	Regency A (2)
3/21/2023	4:45 PM	6:00 PM	WG Guide for DGA in LTCs C57.139	IF	R. Frotscher	Milwaukee (2)
3/22/2023	3:00 PM	4:15 PM	SC Insulating Fluids	IF	S. Reed	Executive Ballroom (2)
3/20/2023	11:00 AM	12:15 PM	WG Loading Guide PC57.91	Ins Life	D. Wallach	Executive Ballroom (2)
3/20/2023	1:45 PM	3:00 PM	WG App of High-Temp Insulation Mats IEEE 1276 Annex B	Ins Life	K. Biggie	Gilpatrick (1)
3/21/2023	3:15 PM	4:30 PM	TF Continuous Rev Clause 11 Temp Rise Tests C57.12.90	Ins Life	D. Sankarakurup	Regency B (2)
3/22/2023	8:00 AM	9:15 AM	SC Insulation Life	Ins Life	S. Sharpless	Regency AB (2)
3/21/2023	8:00 AM	9:15 AM	WG Power-Line Carrier Coupling Cap & Volt Transf. C57.13.9	Instr TR	Z. Roman	Milwaukee (2)
3/21/2023	9:30 AM	10:45 AM	TF Instrument Transf. Accuracy	Instr TR	I. Ziger	Gilpatrick (1)
3/21/2023	11:00 AM	12:15 PM	WG Requirements for Instrument Transformers PC57.13	Instr TR	D. Wallace	Milwaukee (2)
3/22/2023	8:00 AM	9:15 AM	SC Instrument Transformers	Instr TR	T. Sizemore	Executive Ballroom (2)
3/22/2023	7:00 AM	8:00 AM	SC Meetings Planning - Arrive early and grab breakfast from Regency AB - All interested individuals welcome	Mtgs	T. Behrens	Crystal (2)

## SUBCOMMITTEE MEETING LIST

## SPRING 2023 MEETING: MARCH 19 TO MARCH 23

Hyatt Regency; Milwaukee, WI USA

Date	Time Start	Time End	Session Title	Track	Chair	Room/Location
3/20/2023	9:30 AM	10:45 AM	WG Guide of FRA for Liquid Filled Transf. C57.149	PCS	C. Sweetser	Lakeshore Ballroom (1)
3/20/2023	1:45 PM	3:00 PM	TF Audible Sound Revs & WG Sound Guide C57.136 (S. Antosz)	PCS	R. Girgis	Regency B (2)
3/20/2023	3:15 PM	4:30 PM	TF PCS Cont. Revisions to C57.12.00	PCS	T. Ansari	Regency B (2)
3/20/2023	4:45 PM	6:00 PM	TF Inverter Transf Precautions on Ground Shields C57.159	PCS	P. Hopkinson	Executive Ballroom (2)
3/21/2023	9:30 AM	10:45 AM	TF PCS Cont. Rev. to Test Code C57.12.90	PCS	H. Sahin	Regency B (2)
3/21/2023	11:00 AM	12:15 PM	WG Sw Transients Ind by TR/Bkr Interaction PC57.142	PCS	J. McBride	Executive Ballroom (2)
3/21/2023	4:45 PM	6:00 PM	WG Neutral Grounding Devices C57.32	PCS	S. Kennedy	Executive Ballroom (2)
3/22/2023	3:00 PM	4:15 PM	SC Performance Characteristics	PCS	R. Verdolin	Regency AB (2)
3/20/2023	9:30 AM	10:45 AM	TF Guide for Tank Rupture Mitigation C57.156	Power	P. Zhao	Regency A (2)
3/20/2023	9:30 AM	10:45 AM	WG Standard Requirements for Tap Changers - C57.131	Power	C. Colopy	Milwaukee (2)
3/20/2023	11:00 AM	12:15 PM	WG Class 1E Transf. for Nuclear Power Gen Std. 638	Power	C. Swinderman	Regency A (2)
3/20/2023	1:45 PM	3:00 PM	WG Guide for Phase Shifting Transf C57.135	Power	E. Schweiger	Regency A (2)
3/20/2023	3:15 PM	4:30 PM	WG Transformer Monitoring C57.143	Power	M. Spurlock	Lakeshore Ballroom (1)
3/20/2023	4:45 PM	6:00 PM	WG Failure Investigation & Reporting PC57.125	Power	H. Sahin	Regency B (2)
3/21/2023	8:00 AM	9:15 AM	TF Guide for Life Tests of Switch Contacts C57.157	Power	A. Sewell	Gilpatrick (1)
3/21/2023	8:00 AM	9:15 AM	WG Condition Assessment Guide PC57.170	Power	K. Mani	Lakeshore Ballroom (1)
3/21/2023	9:30 AM	10:45 AM	WG Transportation Issues C57.150	Power	G. Anderson	Executive Ballroom (2)
3/21/2023	11:00 AM	12:15 PM	TF Standard Requirements for Arc Furnace Transf. C57.17	Power	D. Corsi	Regency B (2)
3/21/2023	1:45 PM	3:00 PM	WG Volts per Hertz C57.107	Power	J. Watson	Regency B (2)
3/21/2023	3:15 PM	4:30 PM	TF Guide for Install & Maintenance of Power Trf C57.93	Power	S. Reed	Lakeshore Ballroom (1)
3/21/2023	4:45 PM	6:00 PM	TF Guide for Paralleling Transformers C57.153	Power	M. Tostrud	Regency B (2)
3/22/2023	1:30 PM	2:45 PM	SC Power Transformers	Power	R. Musgrove	Regency AB (2)
3/20/2023	9:30 AM	10:45 AM	TF IEEE-IEC Cross Reference	Stds	A. Washburn	Gilpatrick (1)
3/20/2023	9:30 AM	10:45 AM	WG Std Transf. Terminology C57.12.80	Stds	D. Sauer	Executive Ballroom (2)
3/20/2023	11:00 AM	12:15 PM	WG Guide for Field Testing PC57.152	Stds	M. Ferreira	Milwaukee (2)
3/21/2023	3:15 PM	4:30 PM	WG Geomagnetic Disturbances PC57.163	Stds	D. Blaydon	Executive Ballroom (2)
3/21/2023	4:45 PM	6:00 PM	TF Reverse Power Flow Effects on Trans	Stds	D. Blaydon	Lakeshore Ballroom (2)
3/22/2023	4:30 PM	5:45 PM	SC Standards	Stds	D. Sauer	Regency AB (2)
3/20/2023	1:45 PM	3:00 PM	WG Sec. Network Protectors C57.12.44	STNP	M. Faulkner	Lakeshore Ballroom (1)
3/20/2023	4:45 PM	6:00 PM	WG Submersible Transf. C57.12.24	STNP	B. Garcia	Milwaukee (2)
3/21/2023	11:00 AM	12:15 PM	WG Liquid-immersed Sec. Network TRs C57.12.40	STNP	J. Vartanian	Lakeshore Ballroom (1)
3/21/2023	1:45 PM	3:00 PM	WG Guide for Mitigating Corrosion on Sub Trfs C57.12.53	STNP	W. Elliott	Regency A (2)
3/22/2023	11:00 AM	12:15 PM	SC Submersible Transf. & Network Protectors	STNP	G. Payerle	Executive Ballroom (2)